

The Estate Agent People Recommend



2, Rhodesia Villas Lodge Road,
Whistley Green
RG10 0EW

£525,000



Wentworth Estate Agents have pleasure in offering to the market a characteristic THREE BEDROOM SEMI DETACHED HOUSE within Whistley Green, walking distance to Twyford station. The property offers the country cottage feel and stunning rural walks on the doorstep to Dinton Pastures and a 20 minute walk to Twyford station.

Ground floor accommodation comprises of entrance hall, living room with log burner, dining room and kitchen with eye and base level units and access to the garden.

First floor accommodation comprises of two double bedrooms and a further smaller bedroom, family bathroom with bath and shower over, WC and wash hand basin.

Further benefits include gas central heating, parking for two cars on driveway, solar panels, good size garden, side access and garage. The property benefits with a large loft space with velux windows and boarded, a fabulous opportunity to extend, STPP.

This property must be viewed. NO CHAIN.

EPC - D

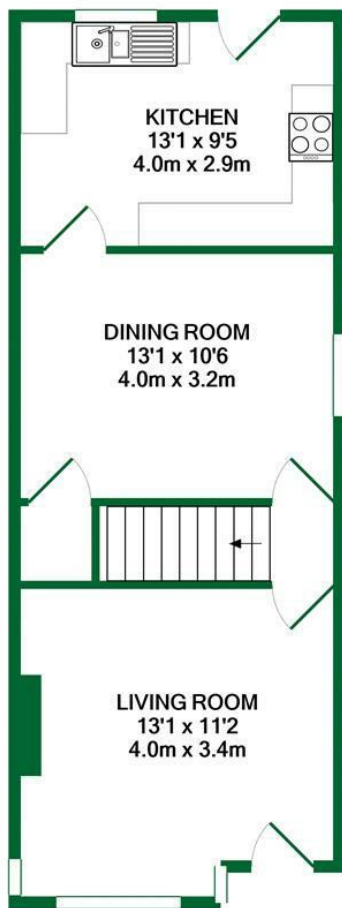

GROUND FLOOR

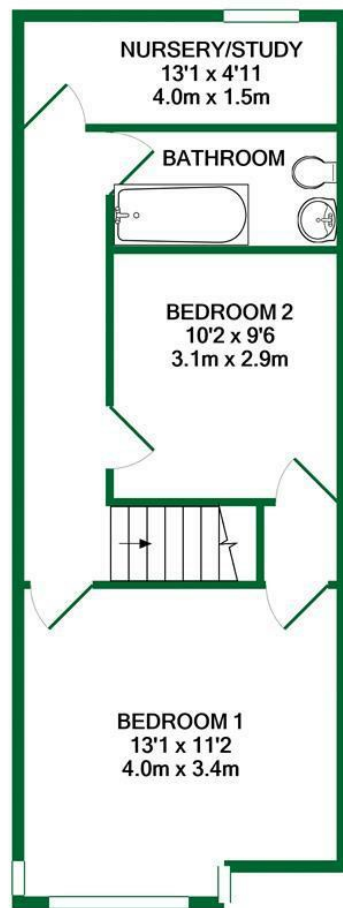

1ST FLOOR

TOTAL APPROX. FLOOR AREA 904 SQ.FT. (84.0 SQ.M.)

Whilst every attempt has been made to ensure the accuracy of the floor plan contained here, measurements of doors, windows, rooms and any other items are approximate and no responsibility is taken for any error, omission, or mis-statement. This plan is for illustrative purposes only and should be used as such by any prospective purchaser. The services, systems and appliances shown have not been tested and no guarantee as to their operability or efficiency can be given
Made with Metropix ©2021

ACCOMMODATION

- THREE BEDROOM SEMI-DETACHED
- GARAGE
- GOOD SIZE GARDEN
- TWO DOUBLE BEDROOMS
- OPPORTUNITY TO EXTEND (SUBJECT TO PLANNING)
- PARKING AT THE FRONT
- WALKING DISTANCE TO TWYFORD VILLAGE AND STATION
- SOLAR PANELS
- NO CHAIN



The Old Butchers, 15 High Street, Twyford, Berkshire, RG10 9AB
t: 0118 934 0027 e: twyford@wentworthea.com

IMPORTANT: we would like to inform prospective purchasers that these sales particulars have been prepared as a general guide only. A detailed survey has not been carried out, nor the services, appliances and fittings tested. Room sizes should not be relied upon for furnishing purposes and are approximate. If floor plans are included, they are for guidance only and illustration purposes only and may not be to scale. If there are any important matters likely to affect your decision to buy, please contact us before viewing the property.



wentworthea.com



wentworth_ea



wentworthestateagents